

## 148C / 150C Actuator Conversion Instructions

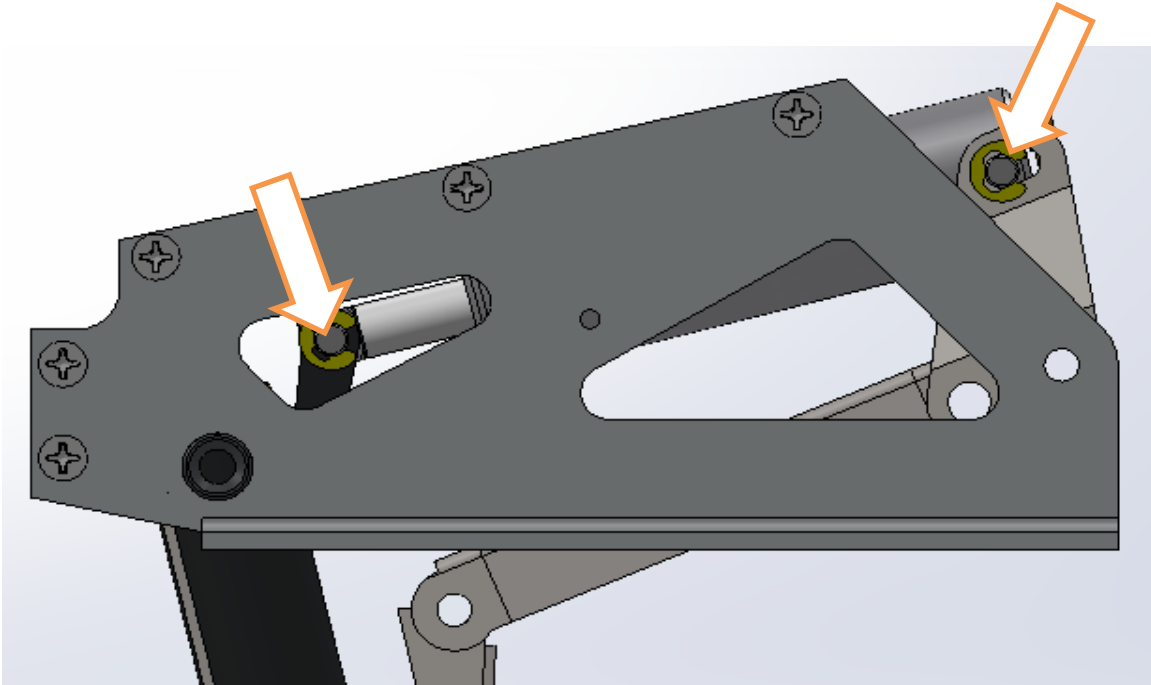

- 1) Slightly retract unit so you can gain access to both the retain rings and clevis pins holding the cylinder to the trunion and upper lift bracket. Remove both clips and pins and save. Remove cylinder as well.

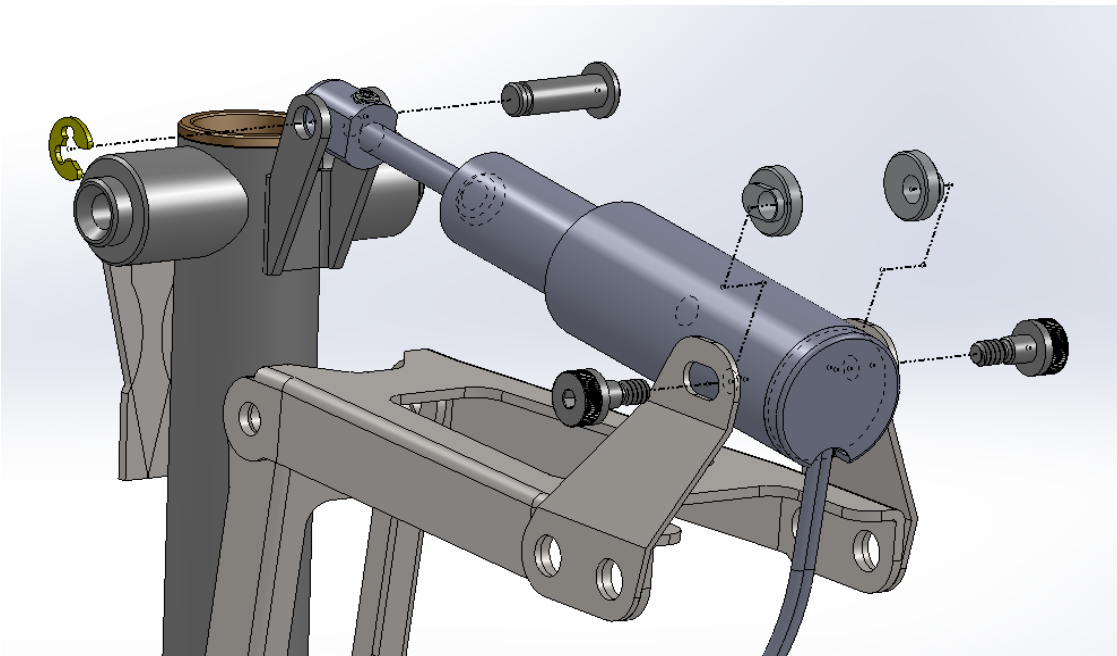

- 2) Re-assemble short clevis pin and retaining clip to trunion as before. Assemble actuator to lift bracket as shown above. Provided bushings will seat in slot with the through hole to the rear of the retract. Use blue threadlocker on screws.

**robart mfg**

625 N. 12<sup>th</sup> St., St. Charles, IL 60174

PH: 630-584-7616

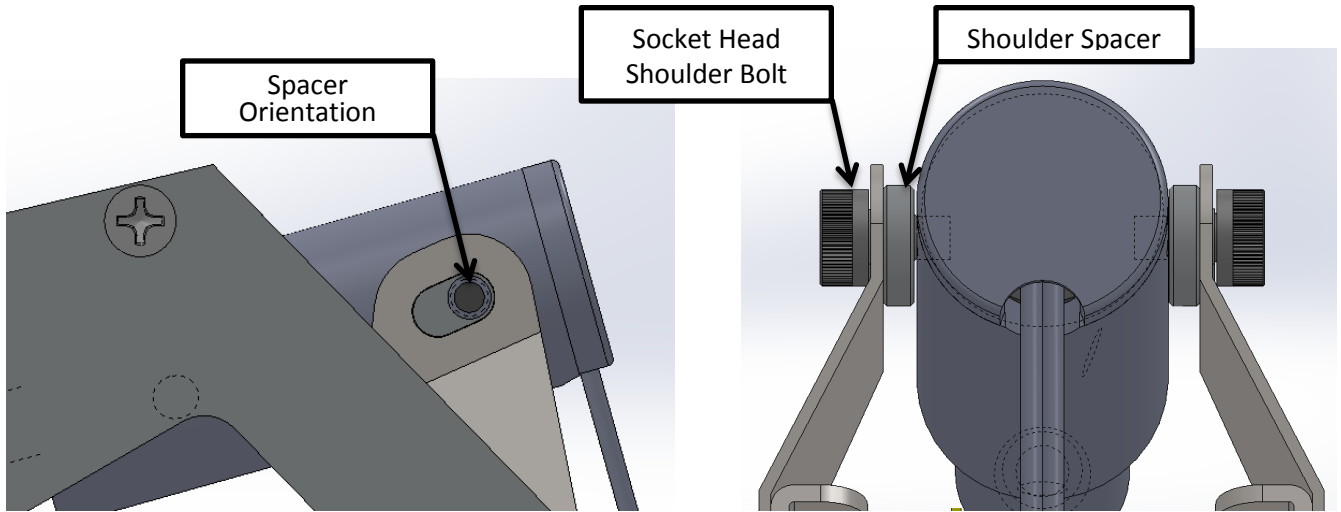

- 3) Spacer has a machined boss that will fit into the slot on the actuator bracket. Larger flat surface will rest against actuator housing as shown above.

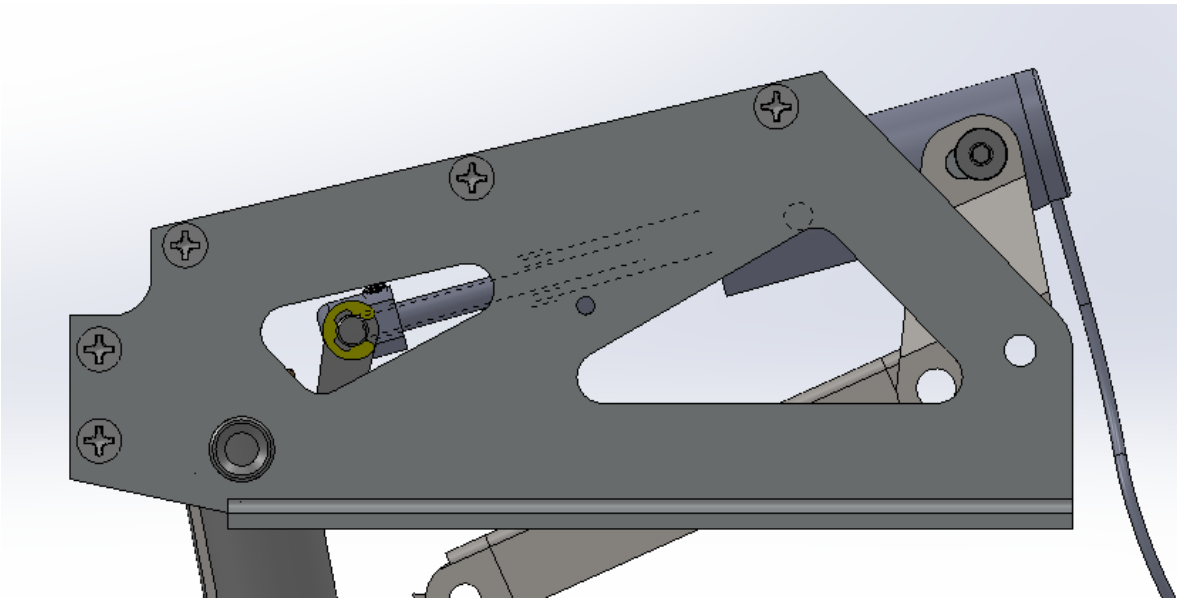

- 4) With all parts re-assembled as shown above, the conversion is complete.