

# READ THIS BEFORE PROCEEDING !

## HOW TO INSTALL THE ROBART GP-RYAN ROBOSTRUTS FOR THE GREAT PLANES GIANT RYAN STA

1. Your Robart GP-RYAN RoboStruts do not use any part of the wire landing gear that come with your kit.

2. Mount the leading edge gear wire in the wing. Note that the leading edge wires are marked L & R for LH & RH. (See photo #1) Make sure that the right and left hand wires are mounted in the correct wing panels. (see photo #2)

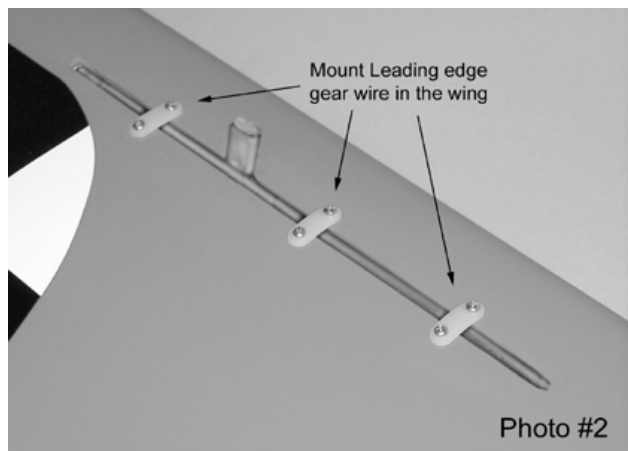
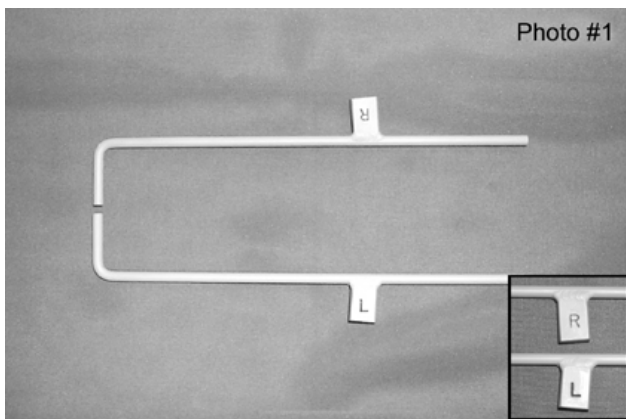

3. Slip the Robart GP-RYAN RoboStrut onto the main gear wire stub. (see photo #3) Install and tighten the set screws that came with the RoboStrut, making sure the strut is pushed in all of the way, and tighten the set screws.

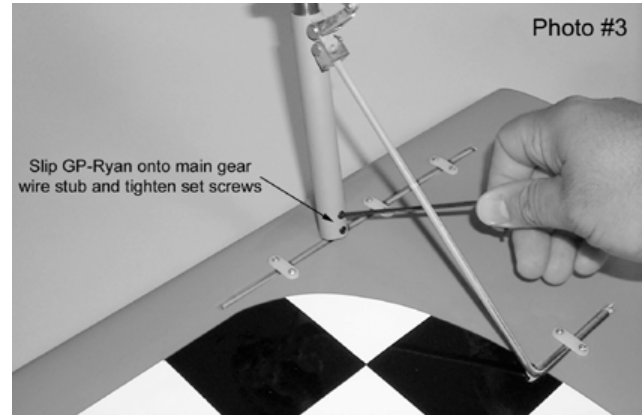

4. Now is the time to adjust the toe-in of the wheels. Mount the new rear strut brace to the wing, and add your wheels to the strut. (The wheels shown in the photos are Robart #13840A1 4 inch "Tuff-Treads" with machined aluminum hubs.) Set the airplane up on the gear and look down over the wing leading edge at the wheels. You will want to have the wheels toed-in slightly, about 1 1/2 to 2 degrees. This will make your plane track better when taking off and rolling out after landing. You adjust the toe-in by loosening the hex head cap screw located just above the wheel fork, that screw locks the torque link mount to the lower oleo strut (See photo #4). Rotate the wheel yoke until you have the desired amount of toe-in and retighten the hex head cap screw.

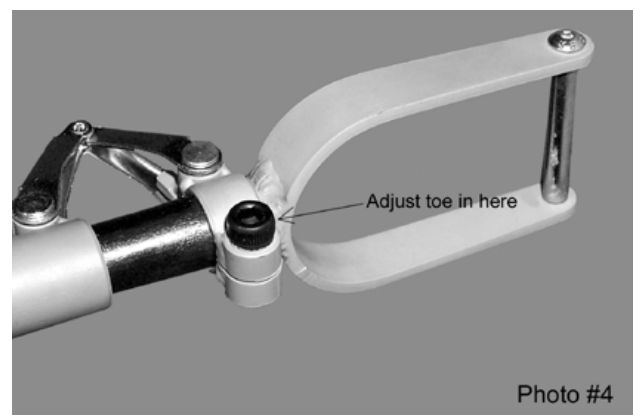

5. To mount the wheel pants, remove the strut and rear brace from the wing, leave the leading edge gear wire mounted in the wing. Determine which wheel pants are right and left, pair them up with the right and left struts. Hold one of the struts by the wheel yoke so the rear brace hangs down next to the strut. Slide the strut through the bottom of the wheel pant until the rear brace comes out of the top. (see photos #5, #6) Remount the strut to the wing, use ZAP Threadlocker on the set screws and tighten all of the screws. (see photo #7) Mount the wheel pants to the wing following the instructions that came with the airplane kit. (see photo #8)

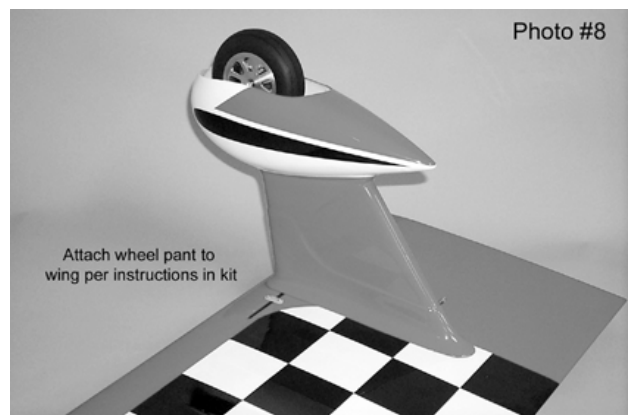
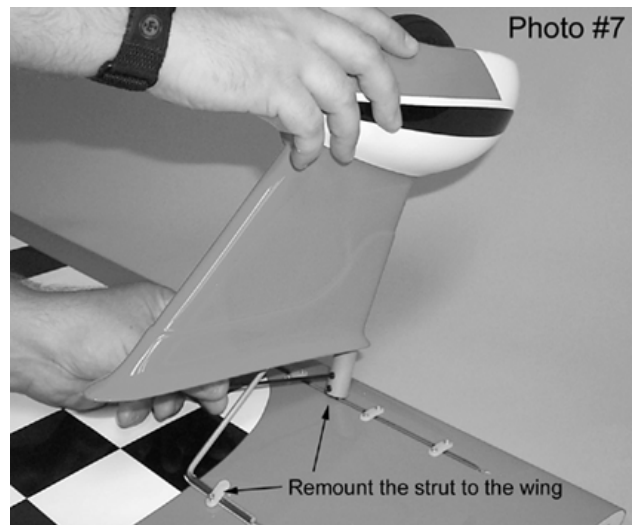
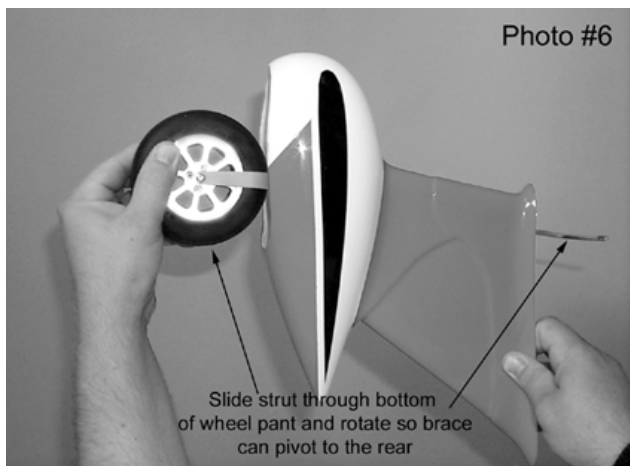

Thank you for purchasing the Robart GP-Ryan RoboStruts.

6. AFTER MOUNTING THESE ROBOSTRUTS, DO NOT ATTEMPT TO FLY YOUR AIRPLANE WITHOUT FIRST CHECKING FOR THE CORRECT CENTER OF GRAVITY. These Robostruts add about 9 oz. to the weight of the airplane and will change your actual center of gravity if your airplane was set up for the wire gear.